

REPLACEMENT PARTS SUITABLE FOR TRAFIMET®

R145™ (Hand) / R145P™ (Machine)

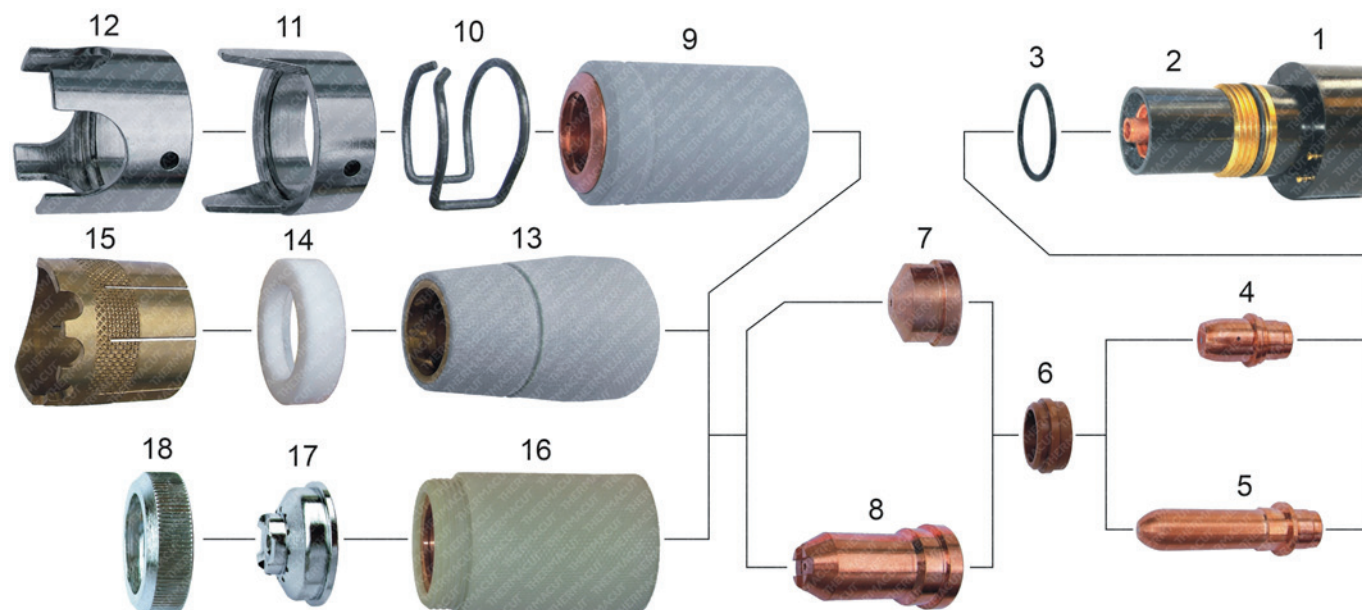

Item	Part No.	Ref. No.	Description	Std. Pkg.	Item	Part No.	Ref. No.	Description	Std. Pkg.
1.	T-5050	PF112	Torch Body, Hand	1	10.	T-3718	CV11	Spacer Spring	5
	T-5049	PF111	Torch Body, Machine	1	11.	T-0643	CV12	Double Pointed Spacer	1
2.	T-11289	T-11289	Insulator (only for TMT torch)	1	12.	T-5003	CV14	Crown Spacer	6
3.	T-3562	EA131	O-Ring	1	13.	T-5017	PC120	Nozzle Retaining Cap	1
4.	T-5064	PR111	Electrode	5	14.	T-5000	BW139	Nozzle Shield	10
5.	T-5065	PR116	Electrode, Long – no thread	5	15.	T-5001	CV1105	Cage Spacer	1
6.	T-5040	PE103	Swirl Ring	2	16.	T-5013	PC103	Contact Nozzle Retaining Cap	1
7.	T-5027	PD109-14	Nozzle 1,4mm	5	17.	T-9371		Spacer for Contact Cutting	1
	T-5028	PD109-16	Nozzle 1,6mm	5	18.	T-9375		Locking Nut	1
	T-5029	PD109-18	Nozzle 1,8mm	5	NS	T-5069	TP12	Insulating Sleeve	1
8.	T-5032	PD117-14	Nozzle, Long 1,4mm	10	NS	T-5068	TP10	Handle with Switch	1
	T-5033	PD117-17	Nozzle, Long 1,7mm	10	NS	KT-1446	PA218	Hand Torch 6m, fittings	1
	T-5034	PD117-19	Nozzle, Long 1,9mm	10	NS	KT-1129	PA250	R145™ Hand Torch 6m, centr.conn.	1
9.	T-10409	PC101	Nozzle Retaining Cap	1	NS	KT-1074	PH151	R145™ Cable Leads 12m, Hand, centr.conn.	1

NS NOT SHOWN IN THE PICTURE

Last update of this page: 18/11/2016. See Revision history for details.

THERMACUT®
THE CUTTING COMPANY

WWW.THERMACUT.CZ
TEL.: +420 556 423 418
SALES@THERMACUT.CZ

WWW.THERMACUT.DE
TEL.: +49 (0) 27 39 40 33 0
INFO@THERMACUT.DE

WWW.THERMACUT.COM
TEL.: 1-603-542-6715
CUSTOMERSERVICE@THERMACUT.COM

THERMACUT®, FHT-EX® AND EX-TRAFIRE® ARE REGISTERED TRADEMARKS OF THERMACUT S. R. O. AND MAY BE REGISTERED IN CZECH REPUBLIC AND/OR OTHER COUNTRIES. ALL OTHER TRADEMARKS ARE PROPERTIES OF THEIR RESPECTIVE OWNERS. THERMACUT IS NO WAY AFFILIATED WITH TRAFIMET®. MOST THERMACUT PARTS ARE MADE FOR OR BY AN IBG COMPANY. PARTS INDICATED WITH A OEM ARE ORIGINAL PARTS MANUFACTURED BY THE ABOVE NAMED MANUFACTURER AND ARE BEING RESOLD BY THERMACUT. THERMACUT RESERVES THE RIGHT TO SUBSTITUTE OEM PARTS IN PLACE OF THERMACUT PARTS. VALID FROM NOVEMBER 2016 • PREVIOUS VERSION IS NO LONGER VALID. • © COPYRIGHT 2016 BY THERMACUT® CZECH REPUBLIC. ALL RIGHTS RESERVED.