

# REPLACEMENT PARTS SUITABLE FOR Hypertherm®

POWERMAX® 1100  
PAC®135T/M

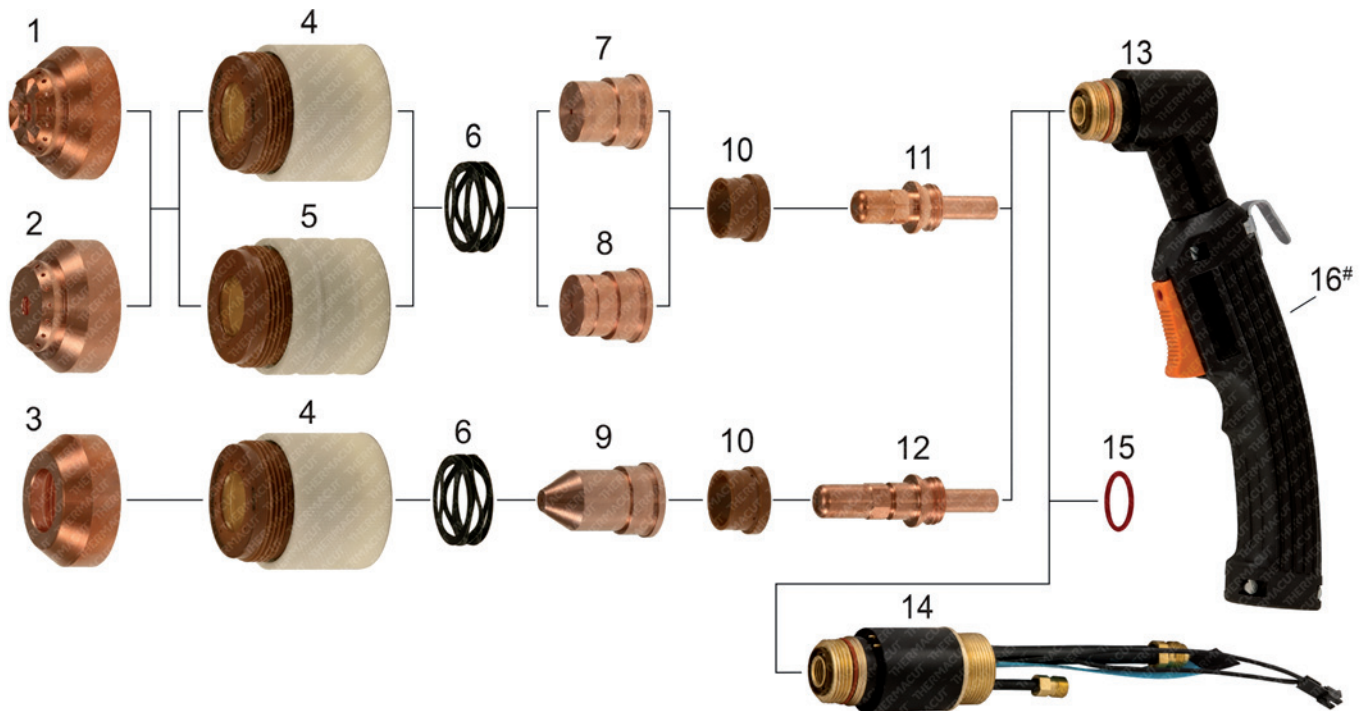

| Item | Part No. | Ref. No.   | Description     | Std. Pkg. | Item    | Part No. | Ref. No.  | Description                   | Std. Pkg. |
|------|----------|------------|-----------------|-----------|---------|----------|-----------|-------------------------------|-----------|
| 1.   | T-2237   | 120475     | Shield, Hand    | 1         | *9.     | T-2532*  | 120518-UR | Nozzle, Extended              | 5         |
| 2.   | T-2238   | 120516     | Shield, Machine | 1         | 10.     | T-2245   | 120474    | Swirl Ring                    | 2         |
| 3.   | T-2239   | 120519     | Deflector       | 1         | 11.     | T-2246   | 120473    | Electrode                     | 5         |
| 4.   | T-2240   | 120483 OEM | Retaining Cap   | 1         | 12.     | T-2247   | 120517    | Electrode, Extended           | 5         |
| 5.   | T-2241   | 120520 OEM | Retaining Cap   | 1         | 13.,16. | T-0537   | 120477    | PAC®135T Torch, Hand + Handle | 1         |
| 6.   | T-2527   | T-2527     | Tip Spring      | 1         | 14.     | T-2842   | 120508    | PAC®135M Torch Machine        | 1         |
| *7.  | T-2531*  | 120476-UR  | Nozzle 80A      | 5         | 15.     | N-10082  | 1-020S    | O-Ring                        | 1         |
| *8.  | T-2530*  | 120515-UR  | Nozzle 40A      | 5         | #16.    | T-1040#  | 9-5636-1  | Handle                        | 5         |

\* FULLY INTERCHANGEABLE WITH ORIGINAL PARTS, BUT DIFFERS FROM ORIGINAL DESIGN

# ONLY FOR THERMACUT TORCH DESIGN

**Last update of this page: 17/11/2015. See Revision history for details.**

**THERMACUT®**  
THE CUTTING COMPANY

WWW.THERMACUT.CZ  
TEL.: +420.556 423 418  
SALES@THERMACUT.CZ

WWW.THERMACUT.DE  
TEL.: +49 (0) 27 39 40 33 0  
INFO@THERMACUT.DE

WWW.THERMACUT.COM  
TEL.: 1-603-542-6715  
CUSTOMERSERVICE@THERMACUT.COM

THERMACUT®, FHT-EX® AND EX-TRAFIRE® ARE REGISTERED TRADEMARKS OF THERMACUT S. R. O. AND MAY BE REGISTERED IN CZECH REPUBLIC AND/OR OTHER COUNTRIES. ALL OTHER TRADEMARKS ARE PROPERTIES OF THEIR RESPECTIVE OWNERS. THERMACUT IS NO WAY AFFILIATED WITH Hypertherm®. MOST THERMACUT PARTS ARE MADE FOR OR BY AN IBG COMPANY. PARTS INDICATED WITH A OEM ARE ORIGINAL PARTS MANUFACTURED BY THE ABOVE NAMED MANUFACTURER AND ARE BEING RESOLD BY THERMACUT. THERMACUT RESERVES THE RIGHT TO SUBSTITUTE OEM PARTS IN PLACE OF THERMACUT PARTS. VALID FROM JUNE 2016 • PREVIOUS VERSION IS NO LONGER VALID. • © COPYRIGHT 2016 BY THERMACUT® CZECH REPUBLIC. ALL RIGHTS RESERVED.