

REPLACEMENT PARTS SUITABLE FOR ESAB®/L-TEC®

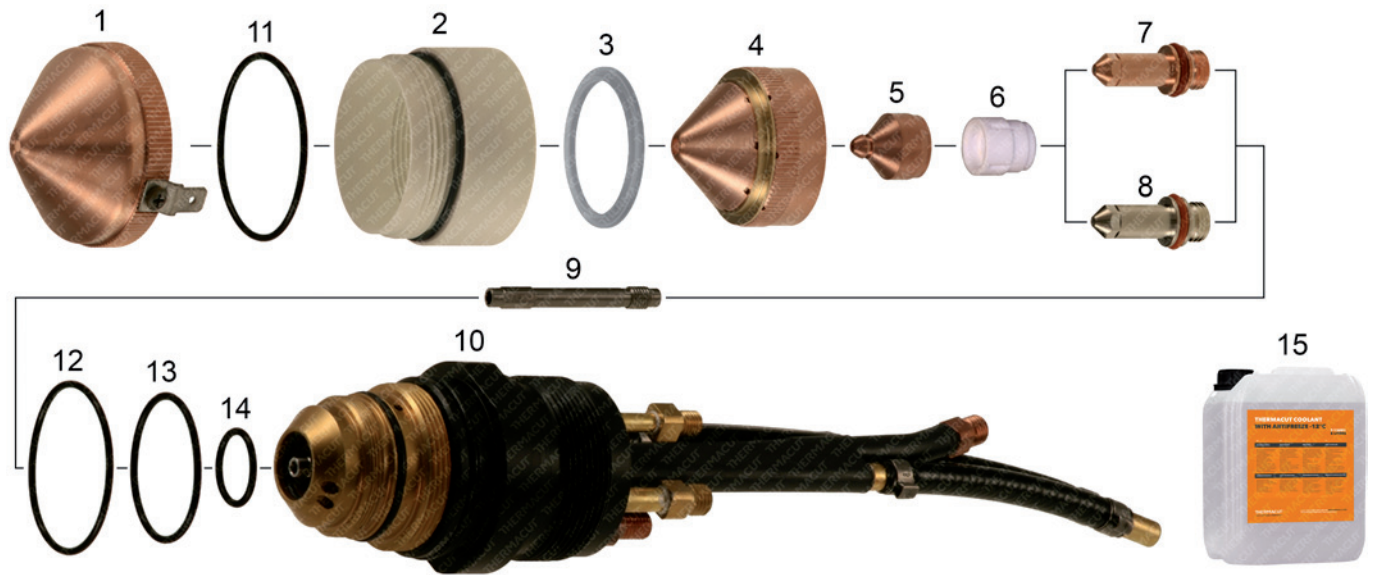

PRODUCT BROCHURE WITH DETAILS AT
WWW.THERMACUT.COM

PT-24™



| Item | Part No. | Ref. No. | Description | Std. Pkg. | Item | Part No. | Ref. No. | Description | Std. Pkg. |
|------|----------|-----------|---------------------------|-----------|------|----------|-----------|---|-----------|
| 1. | T-10130 | 22531 | Cup Shield with Retainer | 1 | 7. | T-3377 | 21539 | Electrode | 5 |
| 2. | T-9333 | 21712 | Insulator Shield Retainer | 1 | | T-8987 | 21539-PRO | Electrode, Silver PRO | 5 |
| 3. | T-3350 | 22010 | Shield Cap Insulator | 1 | 8. | T-4916 | 21539-AG | Electrode, SilverEX® | 5 |
| 4. | T-3353 | 22007 | Nozzle Retainer/Diffuser | 1 | 9. | PT-10625 | 21725 | Water Baffle | 1 |
| 5. | T-3370 | 21540 | Nozzle "A" 15A | 5 | 10. | T-3379 | 21758 | PT-24™ Torch Body, Machine | 1 |
| | T-3371 | 21541 | Nozzle "B" 30A | 5 | 11. | T-1257 | 996528 | O-Ring | 1 |
| | T-3372 | 21542 | Nozzle "C" 50A | 5 | 12. | T-2824 | 950714 | O-Ring | 1 |
| | T-3373 | 21543 | Nozzle "D" 70A | 5 | 13. | T-4019 | 86W62 | O-Ring | 1 |
| | T-3354 | 21923 | Nozzle "E" 100A | 5 | 14. | T-4018 | 638797 | O-Ring | 1 |
| 6. | T-3376 | 21692 OEM | Swirl Baffle 50-100A | 1 | NS | T-3352 | 22008 | Shield Cup 15/30A, Old Design | 1 |
| | T-3374 | 21852 OEM | Swirl Baffle 15A | 1 | NS | T-3351 | 22009 | Shield Cup 50/70A, Old Design | 1 |
| | T-3375 | 21536 OEM | Swirl Baffle 30A | 1 | 15. | | | Coolant Liquid. Details on the page 152, section Accessories. | |

-PRO SILVER PRO TECHNOLOGY INCREASES ELECTRODE LIFETIME SIGNIFICANTLY COMPARED TO STANDARD COPPER ELECTRODES

Last update of this page: 24/02/2017. See Revision history for details.

THERMACUT®
THE CUTTING COMPANY

WWW.THERMACUT.CZ
TEL.: +420 556 423 418
SALES@THERMACUT.CZ

WWW.THERMACUT.DE
TEL.: +49 (0) 27 39 40 33 0
INFO@THERMACUT.DE

WWW.THERMACUT.COM
TEL.: 1-603-542-6715
CUSTOMERSERVICE@THERMACUT.COM

THERMACUT®, FHT-EX® AND EX-TRAFIRE® ARE REGISTERED TRADEMARKS OF THERMACUT, K. S. AND MAY BE REGISTERED IN CZECH REPUBLIC AND/OR OTHER COUNTRIES. ALL OTHER TRADEMARKS ARE PROPERTIES OF THEIR RESPECTIVE OWNERS. THERMACUT IS NO WAY AFFILIATED WITH ESAB®/L-TEC®. MOST THERMACUT PARTS ARE MADE FOR OR BY AN IBG COMPANY. PARTS INDICATED WITH A OEM ARE ORIGINAL PARTS MANUFACTURED BY THE ABOVE NAMED MANUFACTURER AND ARE BEING RESOLD BY THERMACUT. THERMACUT RESERVES THE RIGHT TO SUBSTITUTE OEM PARTS IN PLACE OF THERMACUT PARTS. VALID FROM FEBRUARY 2017 • PREVIOUS VERSION IS NO LONGER VALID. • © COPYRIGHT 2017 BY THERMACUT® CZECH REPUBLIC. ALL RIGHTS RESERVED.